



KLICKITAT COUNTY  
**PUBLIC WORKS DEPARTMENT**



---

228 W. MAIN ST., MS-CH 19, GOLDENDALE WASHINGTON 98620 • FAX 509 773-5713 • VOICE 509 773-4616  
GORDON J. KELSEY; PE: PUBLIC WORKS DIRECTOR

## **Project Update**

### **Bickleton Hwy Overlay Badger Gulch Quarry**

Issued: August 3, 2017

---

This Project will pave the Bickleton Hwy from the Goldendale City limits to Fenton Lane.

Construction work started on July 31, 2017 in the County's Badger Gulch quarry.

Construction work in the quarry will include drilling, blasting, and rock crushing. This work is scheduled Monday through Saturday each week, 18 to 20 hours per day. Work on Sunday is possible. The rock crushing is estimated to continue through early September.

After the crushing work is complete, a portable Hot Mix Asphalt plant will be set up in the Badger Gulch quarry for production of the material to overlay the Bickleton Hwy.

During construction truck traffic will increase on Badger Gulch, Woodland Rd, and the Bickleton Hwy. The production of the products and work needed to complete the project will require day and night time work, and could involve weekend work.

The Public should prepare for traffic delays, noise, and long working days during construction.

Construction is anticipated to continue through October, 2017.

A vicinity map is located on the back of this notice.

If you have questions about this project please call our office at 509-773-4616.

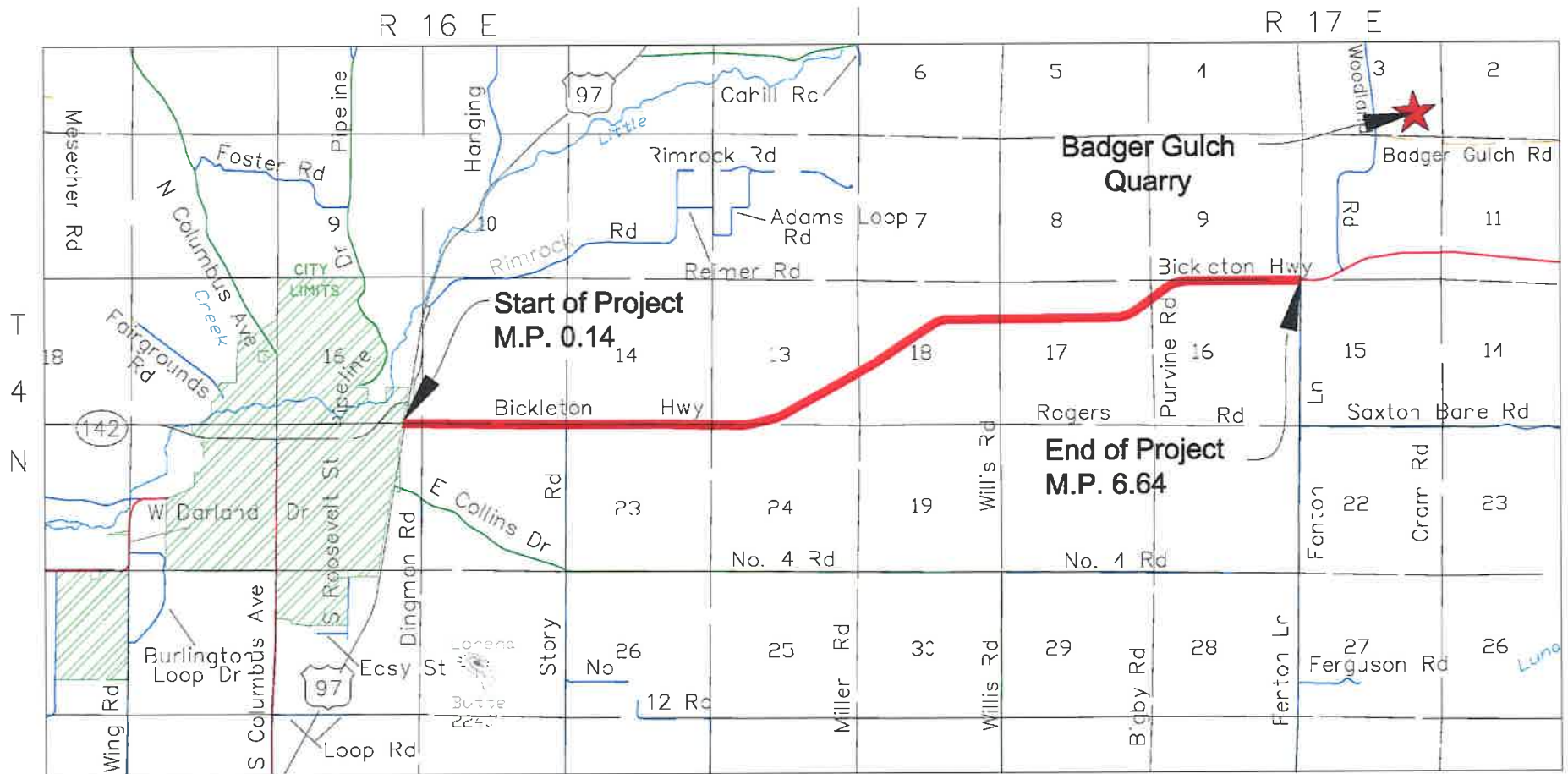

**VICINITY MAP**  
N.T.S